

JAMES EDWARD

Comprehensively Cared For



Otley Terrace

, London, E5 9RG

£3,500 Per Month



Otley Terrace



Description

Recently built three double bedroom, two bathroom terraced house with private garden. Finished to an extremely high specification throughout on a quiet cul de sac street just seconds from Millfields Park and a short walk to Clapton Station.

- Arranged Over Three Floors
- Newly Built House
- Close to Millfields Park
- Private Garden
- Short Walk to Clapton Station
- Available Early June
- Built in storage throughout
- Unfurnished
- Quiet cul de sac location
- Two bathrooms and additional W/C





Floor Plan

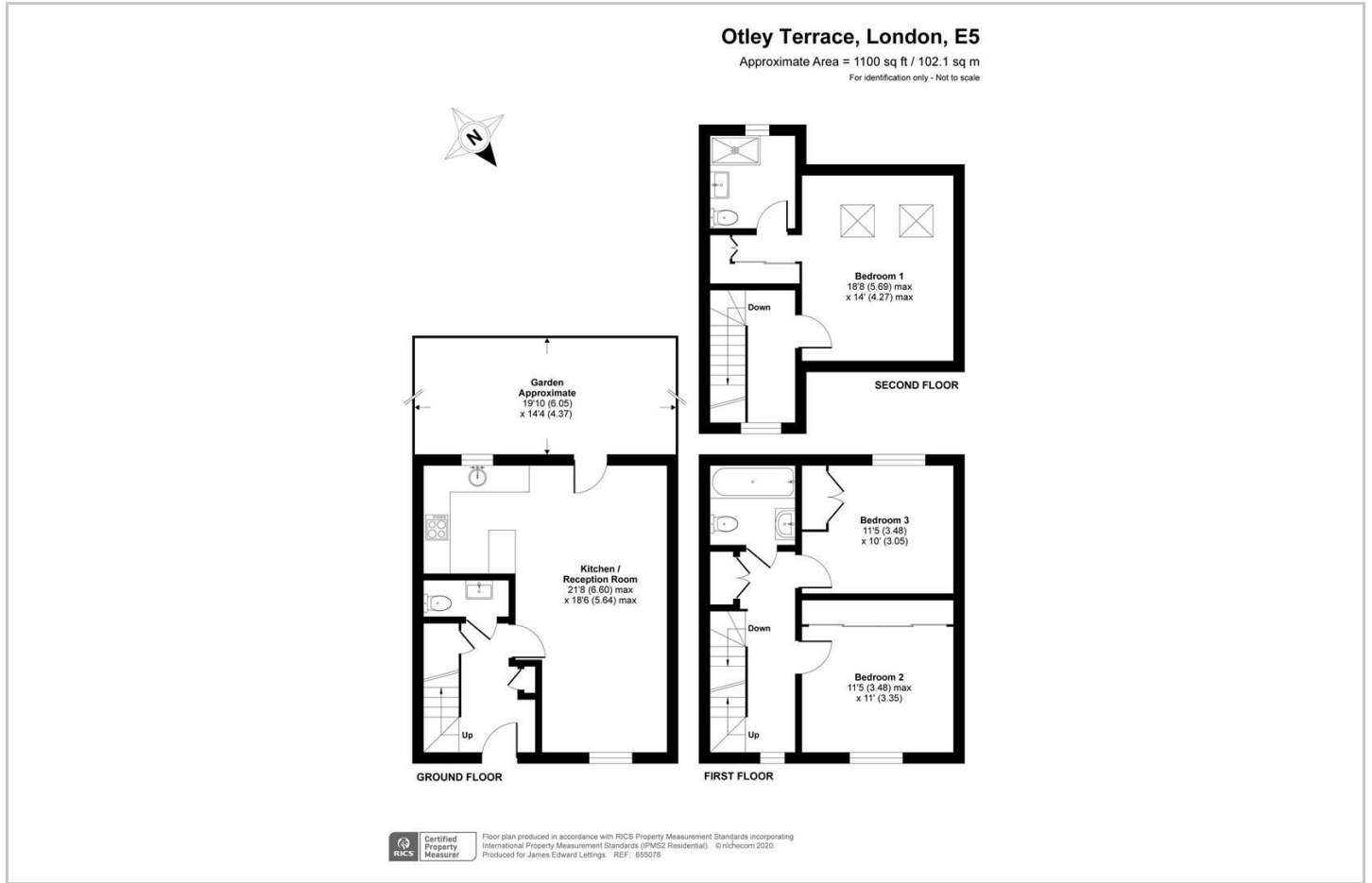

Area Map

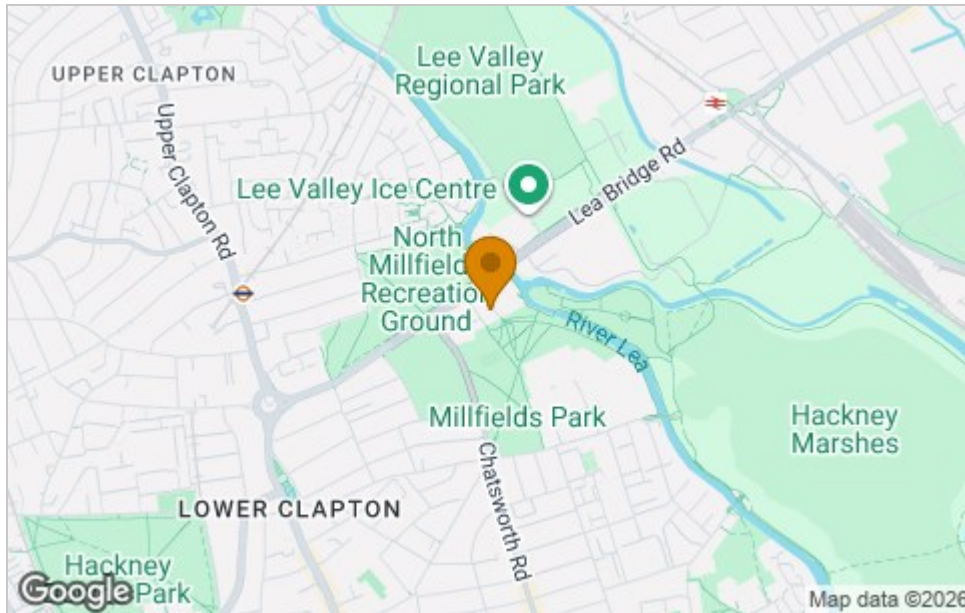

Viewing

Please contact our James Edward Office on 020 7952 5197 if you wish to arrange a viewing appointment for this property or require further information.

These particulars, whilst believed to be accurate are set out as a general outline only for guidance and do not constitute any part of an offer or contract. Intending purchasers should not rely on them as statements of representation of fact, but must satisfy themselves by inspection or otherwise as to their accuracy. No person in this firm's employment has the authority to make or give any representation or warranty in respect of the property.

100 Highbury Park, London, N5 2XE
 Tel: 020 7952 5197 Email: info@jamesedwardproperties.co.uk <https://www.jamesedwardproperties.co.uk>

Energy Efficiency Graph

